

Model 3000 - Parts List

- 1A Main Housing
- 1B Splicer Side Cover
- 3 Wheel Drive Hub
- 4 Wheel Roller
- 6 Tension Adjustment Block
- 8 Belt Mount Bracket
- 9 Tension Adjustment Spring
- 10 Roller Adjustment Spring
- 14 Blade
- 16 Quick Connector
- 118 Waist Belt
- 19 Body Mount Screw
- 21 Belt Mount Screw
- 22 Moveable Roller Bracket
- 23 Moveable Bracket Screw
- 24 Motor Screw
- 28 Roller Screw
- 29 Roller Nut
- 33 Nut for (P/N 23, 21, 19, 55)
- 34 Hub Set Screw
- 35 Hub Cover
- 37 Microswitch
- 38 Knob Screw
- 40A Side Cover Screw
- 40B Side Cover Screw
- 40C Side Cover Screw
- 41 Blade Screw
- 42 Fixer Roller Screw
- 43 Microswitch Screw
- 45 Fixed Roller Washer
- 46 Nut for (P/N 1A)
- 47 Flexible Cord Assembly
- 48 Charger
- 49 Motor
- 49C Plastic Motor Cover
- 50 Battery Pack
- 51 Bullet Plug
- 52 Bullet Receptable
- 53 Spacer/Washer
- 54 Lock Washer
- 55 Belt Assembly Screw
- 56 Belt Plate
- 59H Power Jack Female Harness

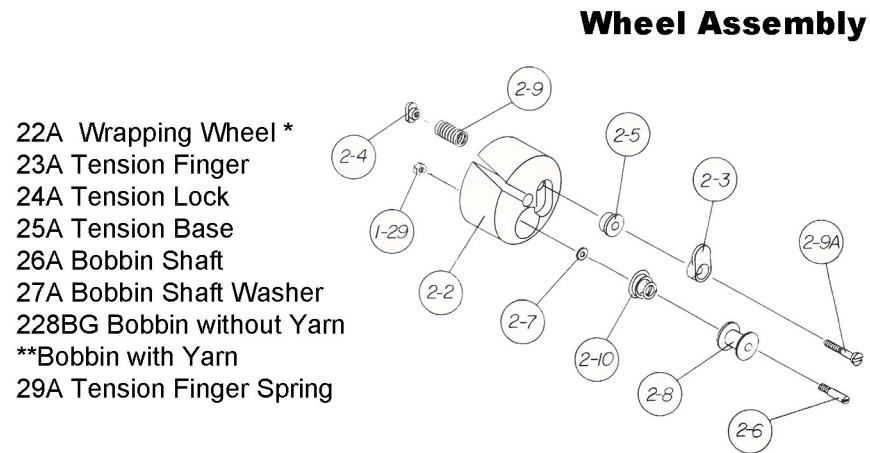
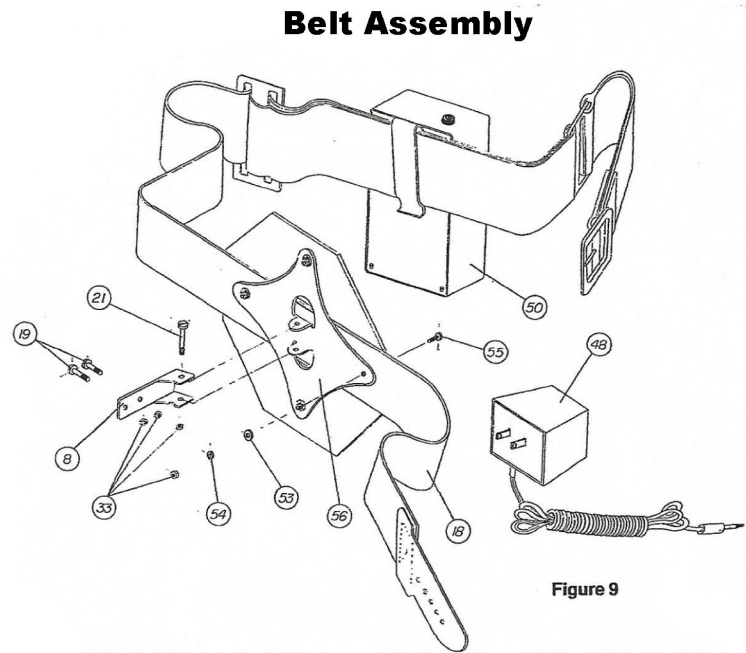
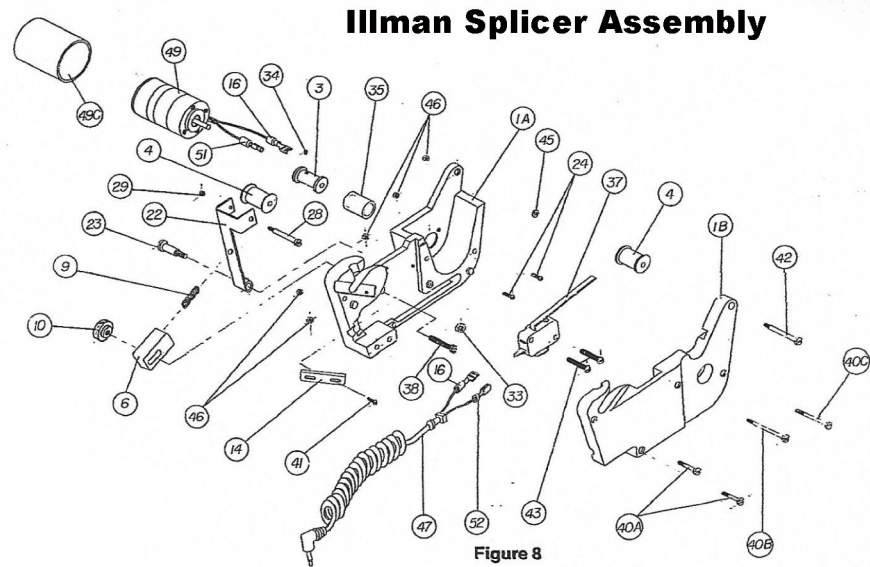

Customer Assistance
Manual

Instructions, Maintenance, Spare Parts



ILLMAN WRAP SPLICER
Model 3000



P.O. Box 518 Gastonia, NC 28053 Ph 704.865.1201 Fax 704.869.0083
E-mail: milldevices@abcarter.com Website: www.abcarter.com

Illman Wrap Splicer Model 3000

The **Illman Wrap Splicer** was designed to join traditional textile yarns and composite fiber tows in processes where knots are objectionable or impossible to tie. This unique splicer produces high-strength, consistent joins in virtually any material within reasonable size limitations -- including: **Fiberglass, Kevlar, Graphite, Polyester, Nylon and Cotton.** The splice is made by tightly wrapping a fine yarn around overlapped ends of the subject yarn.

The standard **Illman Splicer** is mounted on a waistbelt for portability and is powered by a rechargeable battery. The unit includes two battery packs, a charger, two wrap wheels and two dozen of a specified wrap yarn. (Please see next page for our list of standard wrap yarns) Note: We also offer an optional power supply which would eliminate the need for the rechargeable battery.



The **Illman Splicer** can also be track mounted for efficient operation on many different types of processing materials, including creels.



Note: Other Illman Models (3500 & 3550) are available for splicing extremely coarse materials. For information, please contact your Mill Devices Company representative.

MAKING A SPLICE

1. Begin the splicing operation by overlapping the ends of yarn the desired amount.
2. Place the ends in the wrap wheel slot (See Figures 1 and 2).
3. Press the switch lever at the right of the wrap wheel to begin wheel rotation. (As the wheel rotates, yarn from the bobbin is wound tightly around the ends, joining them securely. The operator controls the length of the splice being made by moving the yarn from side to side while wheel is rotating.
4. The completed splice is removed from the slot of the splicing wheel, and the wrap yarn is then broken. (See Figures 3 and 4).

Tensile strength increases proportionally with the wrapping wheel time and length of splice. The strongest splice is made when the ends are completely overwrapped.

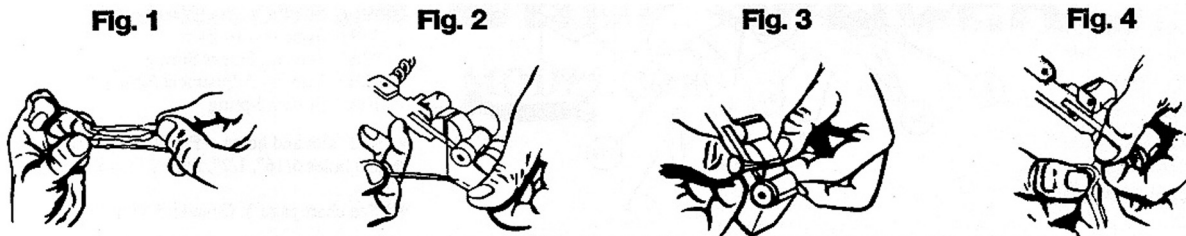

Illman Wrap Splicer Model 3000

General Maintenance:

The splicer should be cleaned frequently to remove lint and yarn from around the wheel rollers (P/N 4) and from between the motor shaft and wheel drive hub (P/N 3). Build-up in these areas many cause friction, resulting in excessive drawing on the batteries. **Note:** Drive system parts that are most likely to need replacement due to wear are the hub cover (P/N 35) and the wheel rollers (P/N 4).

Battery Maintenance:

The standard power pack includes a sealed 2.5 amp/hour lead-acid rechargeable battery. Battery condition always should be checked before operation. A fully charged battery reads 6.4 and 7.5 volts. Operation at a low voltage may decrease the cycle-life of the battery.

A constant-potential charger is furnished with each complete splicer. A solid-state circuit charges the battery to capacity, then decreases the current to maintain full charge. *Normal charging requires 6 - 10 hours, depending on the condition of the battery.*

WRAP YARN - REPLACING BOBBINS (Refer to Diagram)

The wrap yarn is fed from a small bobbin located in the wrap wheel. To replace the empty bobbin, remove the wheel from the splicer by lifting it upward. Then remove the empty bobbin from the wheel by pushing in on the tension lock (P/N 24A) - This is located on the opposite side of the splicing wheel. Rotate the tension finger (P/N 23A) and remove the bobbin. Place a full bobbin in the wheel (reversing the sequence above). Then pull the wrap yarn from the bobbin under the tension finger around the tension adjustment screw (P/N 29AB) and then through the center of the splicing wheel. The bobbin must rotate counterclockwise.

Place the replenished wheel in the splicer with the bobbin side next to the motor. Before starting a splice, the wrap yarn must be pulled about an inch to the right of the wrap wheel.

Different wrap yarns are available. Our standard wrap yarns are listed at the right.....

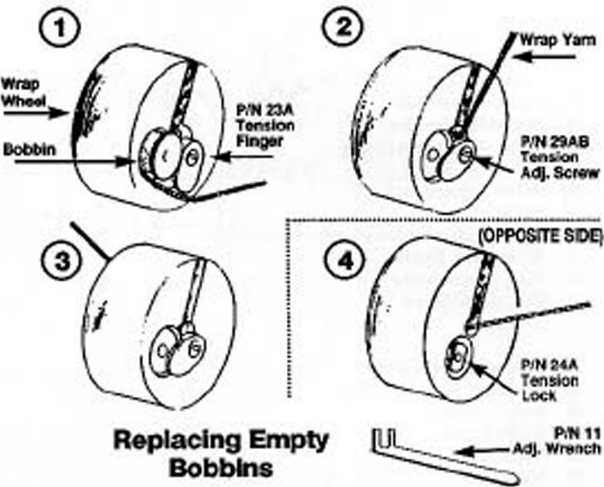

****Always check tension of the wrap yarn after rethreading the wrap wheel. A weak splice may result if the yarn is not properly installed under the tension assembly. Tension may be adjusted by turning the tension adjustment screw (P/N 29AB) while holding the tension adjustment nut (P/N 24A).****

Standard Wrap Yarns

#5 Monofilament.....	(#212AG)
70 Denier Nylon.....	(#213AG)
75/2 Cotton - Plied.....	(#215AG)
50/2 Spun Poly.....	(#217AG)
30/1 Kevlar.....	(#220AG)
30/1 Nomex (cream, green or black)...	(#221AG)